

# Technisches Datenblatt

Seite: 1/2

## PRKSSF Rohrkabelschuhe für feindrähtige Leitung

- Für fein- und feinstdrähtige Rundleiter nach VDE 0295 Klasse 5 (flexibler Leiter) und 6 (hochflexibler Leiter)
- Anwendung z.B. Schaltschrankbau, Industrie usw.
- Cu-ETP nach DIN EN13600
- Aufgeweitete Hülse zur einfachen Kabeleinführung
- Galvanisch verzinkt, mit Sichtloch
- Wärmebeständig bis +125°C
- Mit Kennziffer zur eindeutigen Werkzeugzuordnung
- Passendes Werkzeug: PPZKS 6-300
- Unisoliert



### Informationen

Art.-Nr.	ID-Nr.	Type	MVE	VPE	Flanschloch für Bolzen	Querschnitt	Kennziffer
05105063	055593	PRKSSF 10/M5	1	100	M5	10 mm <sup>2</sup>	10
05105064	055594	PRKSSF 10/M6	1	100	M6	10 mm <sup>2</sup>	10
05105065	055595	PRKSSF 10/M8	1	100	M8	10 mm <sup>2</sup>	10
05105066	055596	PRKSSF 10/M10	1	100	M10	10 mm <sup>2</sup>	10
05105067	055597	PRKSSF 16/M5	1	100	M5	16 mm <sup>2</sup>	16
05105068	055598	PRKSSF 16/M6	1	100	M6	16 mm <sup>2</sup>	16
05105069	055599	PRKSSF 16/M8	1	100	M8	16 mm <sup>2</sup>	16
05105070	055600	PRKSSF 16/M10	1	100	M10	16 mm <sup>2</sup>	16
05105071	055601	PRKSSF 25/M6	1	50	M6	25 mm <sup>2</sup>	25
05105072	055602	PRKSSF 25/M8	1	50	M8	25 mm <sup>2</sup>	25
05105073	055603	PRKSSF 25/M10	1	50	M10	25 mm <sup>2</sup>	25
05105074	055604	PRKSSF 25/M12	1	50	M12	25 mm <sup>2</sup>	25
05105075	055605	PRKSSF 35/M6	1	50	M6	35 mm <sup>2</sup>	35
05105076	055606	PRKSSF 35/M8	1	50	M8	35 mm <sup>2</sup>	35
05105077	055607	PRKSSF 35/M10	1	50	M10	35 mm <sup>2</sup>	35
05105078	055608	PRKSSF 35/M12	1	50	M12	35 mm <sup>2</sup>	35
05105079	055609	PRKSSF 50/M8	1	25	M8	50 mm <sup>2</sup>	50
05105080	055610	PRKSSF 50/M10	1	25	M10	50 mm <sup>2</sup>	50
05105081	055611	PRKSSF 50/M12	1	25	M12	50 mm <sup>2</sup>	50
05105082	055612	PRKSSF 70/M8	1	25	M8	70 mm <sup>2</sup>	70
05105083	055613	PRKSSF 70/M10	1	25	M10	70 mm <sup>2</sup>	70
05105084	055614	PRKSSF 70/M12	1	25	M12	70 mm <sup>2</sup>	70
05105085	055615	PRKSSF 95/M8	1	25	M8	95 mm <sup>2</sup>	95
05105086	055616	PRKSSF 95/M10	1	25	M10	95 mm <sup>2</sup>	95

# Technisches Datenblatt

Seite: 2/2

## PRKSSF Rohrkabelschuhe für feindrätige Leitung

Art.-Nr.	ID-Nr.	Type	MVE	VPE	Flanschloch für Bolzen	Querschnitt	Kennziffer
05105087	055617	PRKSSF 95/M12	1	25	M12	95 mm <sup>2</sup>	95
05105088	055618	PRKSSF 120/M10	1	25	M10	120 mm <sup>2</sup>	120
05105089	055619	PRKSSF 120/M12	1	25	M12	120 mm <sup>2</sup>	120
05105090	055620	PRKSSF 150/M10	1	10	M10	150 mm <sup>2</sup>	150
05105091	055621	PRKSSF 150/M12	1	10	M12	150 mm <sup>2</sup>	150
05105092	055622	PRKSSF 185/M12	1	10	M12	185 mm <sup>2</sup>	185
05105093	055623	PRKSSF 185/M16	1	10	M16	185 mm <sup>2</sup>	185
05105094	055624	PRKSSF 240/M12	1	10	M12	240 mm <sup>2</sup>	240
05105095	055625	PRKSSF 240/M16	1	10	M16	240 mm <sup>2</sup>	240

ITEM NO.	WIRE RANGE	d <sub>1</sub>	l <sub>1</sub>	b	l <sub>2</sub>	d <sub>2</sub>	d <sub>3</sub>
05105063	10 mm <sup>2</sup>	5,5	28,5	12,0	14,0	5,3	8,0
05105064		5,5	28,5	12,0	14,0	6,4	8,0
05105065		5,5	31,5	16,0	14,0	8,4	8,0
05105066		5,5	32,5	16,0	14,0	10,5	8,0
05105067	16 mm <sup>2</sup>	6,6	31,0	14,0	15,0	5,3	9,5
05105068		6,6	31,0	14,0	15,0	6,4	9,5
05105069		6,6	34,0	16,0	15,0	8,4	9,5
05105070		6,6	35,0	16,0	15,0	10,5	9,5
05105071	25 mm <sup>2</sup>	7,9	34,0	16,0	17,0	6,4	11,0
05105072		7,9	36,0	17,0	17,0	8,4	11,0
05105073		7,9	38,0	17,0	17,0	10,5	11,0
05105074		7,9	39,0	19,0	17,0	13,0	11,0
05105075	35 mm <sup>2</sup>	9,2	35,5	18,0	19,0	6,4	12,5
05105076		9,2	37,5	18,0	19,0	8,4	12,5
05105077		9,2	40,0	18,0	19,0	10,5	12,5
05105078		9,2	41,0	19,0	19,0	13,0	12,5
05105079	50 mm <sup>2</sup>	11,0	42,0	21,8	21,0	8,4	15,0
05105080		11,0	43,0	21,8	21,0	10,5	15,0
05105081		11,0	46,0	21,8	21,0	13,0	15,0

NOTE : Standard, according to EN 13600

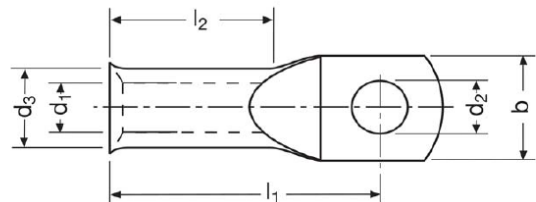

ITEM NO.	WIRE RANGE	d <sub>1</sub>	l <sub>1</sub>	b	l <sub>2</sub>	d <sub>2</sub>	d <sub>3</sub>
05105082	70 mm <sup>2</sup>	13,1	47,0	25,0	25,0	8,4	17,0
05105083		13,1	48,0	25,0	25,0	10,5	17,0
05105084		13,1	50,0	25,0	25,0	13,0	17,0
05105085	95 mm <sup>2</sup>	14,5	52,0	28,0	26,0	8,4	19,0
05105086		14,5	52,0	28,0	26,0	10,5	19,0
05105087		14,5	53,0	28,0	26,0	13,0	19,0
05105088	120 mm <sup>2</sup>	16,2	57,0	30,0	30,0	10,5	21,0
05105089		16,2	58,0	30,0	30,0	13,0	21,0
05105090	150 mm <sup>2</sup>	18,0	64,0	34,0	32,0	10,5	23,0
05105091		18,0	65,0	34,0	32,0	13,0	23,0
05105092	185 mm <sup>2</sup>	20,6	71,5	37,0	39,5	13,0	26,0
05105093		20,6	77,0	37,0	39,5	17,0	26,0
05105094	240 mm <sup>2</sup>	23,1	77,5	41,0	44,0	13,0	28,0
05105095		23,1	82,0	41,0	44,0	17,0	28,0

NOTE : Standard, according to EN 13600

