

Produkt/Product/ Producto /Изделие	Nr./No./ Núm./ №	Typ/Type/Типо/ Тип	Ø 16 mm	Ø 20 mm	Ø 25 mm	System/Sistema/ Система	Vibrationshammer/Vibration hammer/ Martillo vibrador /Вибромолоток	
Tiefenerder Earth rod Electrodo de puesta a tierra Глубинный заземлитель	1	219... ST	5000730 5000733	5000742 5000750	5000769	ST		
	2	219... BP	-	5000947 5000858 5000866 5000500	5000955	BP		
	3	219... OMEX	-	5000017 5000203	5000025	OMEX		
	4	LE ERDER	-	-	5000300 5000335	LE		
Schlagkopf Driving head Sufridera para picas de tierra Забивная головка	5	1820 16-20	3042260	3042260	-	ST, BP, OMEX		
	6	1820	-	3042200	3042251	ST, BP, OMEX		
	7	LE KOPF	-	-	3042308	LE		
Hammereinsatz Hammer insert Adaptador para martillo Ударный наконечник	8	2500	-	3043207	3043258	ST, BP, OMEX	Cobra BBM 47 SPA-Super, Tex11, Cobra 248	
	9	2520	-	3043703	3043754	ST, BP, OMEX	Wacker BHF 25, BHF 30S, EHU 25/220	
	10	2530	-	3043401	3043452	ST, BP, OMEX	Bosch USH 10, HSH 10	
	11	2531 16	3043904	-	-	ST	Bosch GSH 27, USH 27	
	12	2531 20	-	3043908	-	ST, BP, OMEX	Bosch GSH 27, USH 27	
	13	2535	-	3043916	3044912	ST, BP, OMEX	Hilti TE 52/42, TE 72,60, TE 92	
	14	2536 16	3043930	-	-	ST	SDS-Max, TEY-Aufnahme/mounting/montaje/ крепление	
	15	2536	-	3044904	3044831	ST, BP, OMEX	SDS-Max, TEY-Aufnahme/mounting/montaje/ крепление	
	16	3043606	LE				Wacker BHF 25, BHF 30S	
		3043610	LE				Hilti TE 52/42, TE72/60, TE92	
		3043614	LE				Bosch USH 10, HSH 10	
		3043602	LE				SDS-Max	
		3043618	LE				Atlas Copco (Sechskantaufnahme/Hexagon seat/alojamiento hexagonal/шестигранный)	
		3043628	LE				Bosch GSH27/UH27 (11304) / HS28 (12314) / Hitachi H65SD / Makita HM 1500B / HM1800	
	Schlagspitze Impact point Punta para pica de puesta a tierra Ударный наконечник	17	1819 25 BP	-	-	3041956	ST, BP	
		18	1819 16-20	5450022	5450022	-	ST, BP	
19		1819	-	3041204	3041255	OMEX		
20		LE SPITZE	-	-	3041409	LE		

ST, BP, OMEX, LE

- DE Tiefenerder
Montageanleitung
- EN Earth rod
Mounting instructions
- ES Electrodo de puesta a tierra
Instrucciones de montaje
- RU Глубинный заземлитель
Инструкция по монтажу

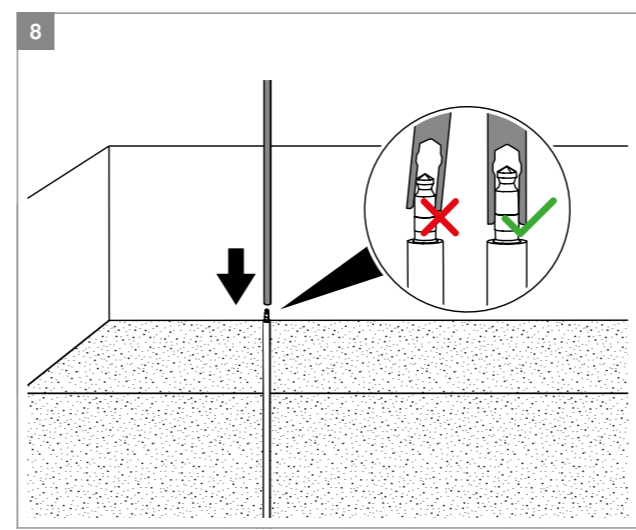
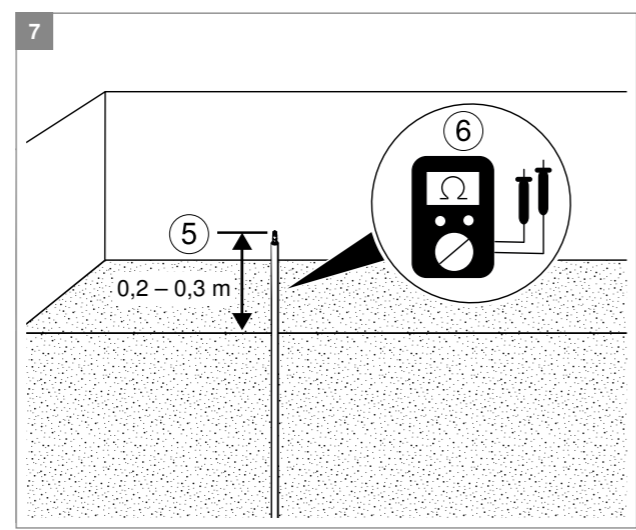
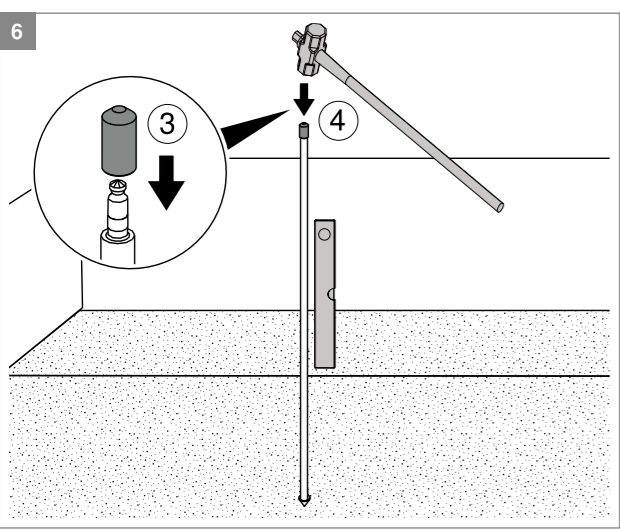
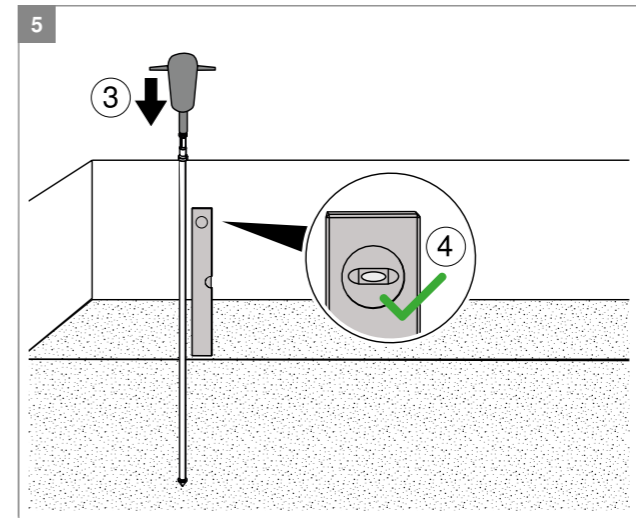
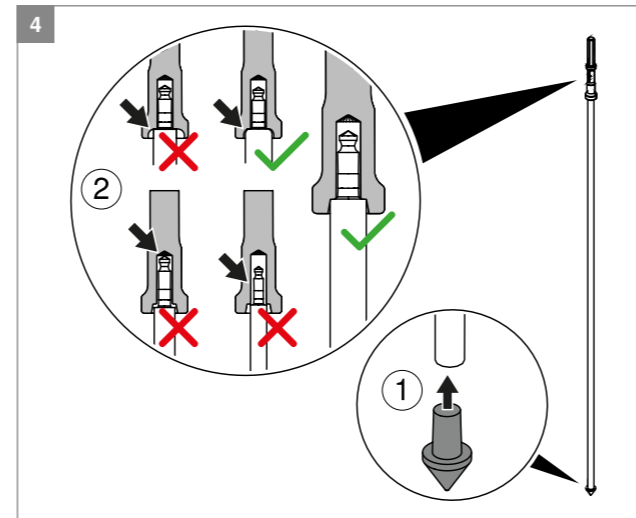
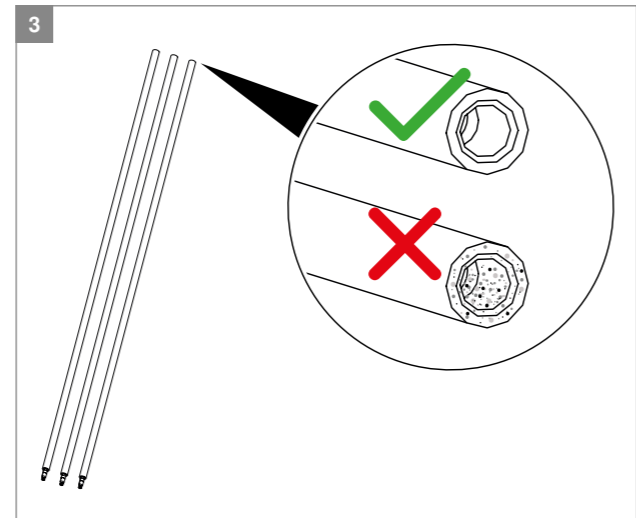
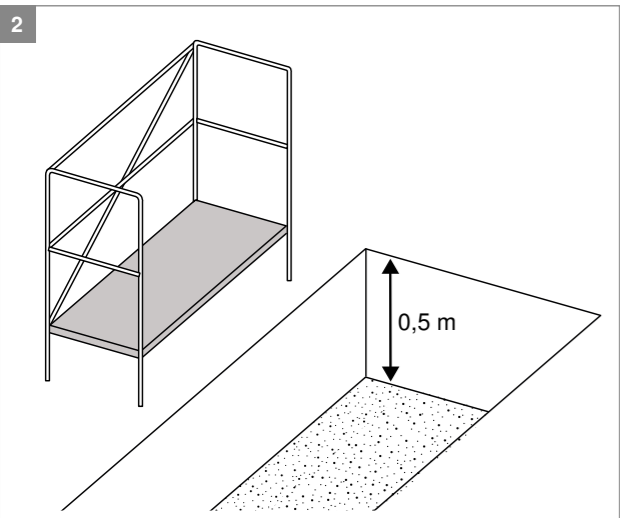
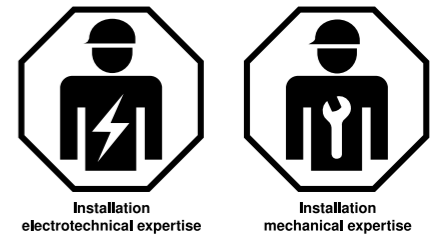

**OBO Bettermann
Holding GmbH & Co. KG**
P. O. Box 1120
58694 Menden
GERMANY
Technical Office
Tel.: +49 2373 89 - 13 00
technical-office@obo.de
www.obo-bettermann.com



Building Connections

