

TECHNISCHE DATEN:

Aufbau

Anschlussgewinde-
Dichtring

Polyethylen PE-LD (low density)

Eigenschaften

- zur besseren Abdichtung am Anschlussgewinde

Temperaturbereich

-30 °C / +90 °C

Hinweis

montierter Dichtring ermöglicht höhere Schutzart

TECHNICAL DATA:

Configuration

Sealing ring for
connecting thread

Polyethylene PE-LD (low density)

Properties

- for improved sealing on the connecting thread

Temperature range

-30 °C / +90 °C

Comment

assembled sealing ring enables higher protection grades

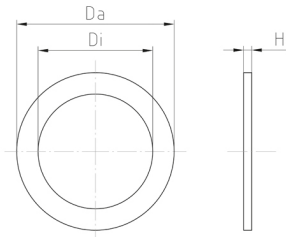

Merkmale

Characteristics

Größe / Size xx	H mm	Da mm	Di mm		Art.-Nr. / Part No.
M12	2	16	12	100	3M12-D
M16	2	20	16	100	3M16-D
M20	2	24	20	100	3M20-D
M25	2	29	25	50	3M25-D
M32	2	36	32	25	3M32-D
M40	2	45	40	10	3M40-D
M50	2	56	50	5	3M50-D
M63	2	70	63	5	3M63-D